

**45° DOVETAIL CUTTER**

Cutting Rake - 11°  
for 11° positive **IDEX** inserts

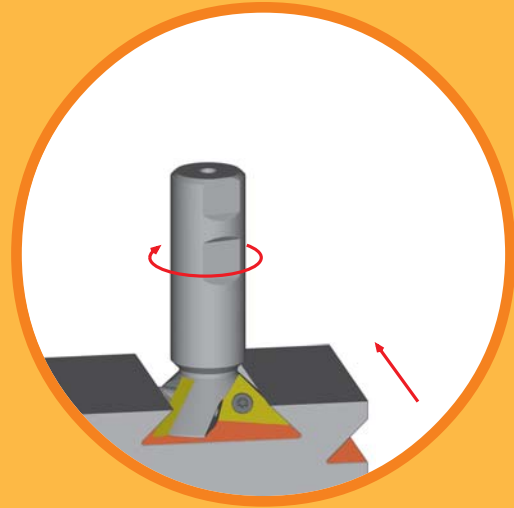

Operation	Tool Rotation	Direction of Cut
45° Dovetail Facing	Right Hand	Horizontal

**Milling Application**

Finishing	Medium	Roughing
Good	Good	Average

**Insert Type**

Steel	Stainless Steel	Cast Iron	Aluminum	High Temper Alloy
TDEX-EN	TDEX-EN	TDEX-EN	TDEX-EN	TDEX-EN

For insert information see pages E-70 to E-71.

**TOOL ANGLES:**

- Cutting Rake +11°
- Axial Rake 0°
- Radial Rake 0°

**FEATURES:**

- Available 3/8", 1/2", 5/8", 3/4", & 1.0" Weldon shank sizes
- Positive **IDEX** inserts, 15° clearance
- High rate of material removal
- Torx screw locking system

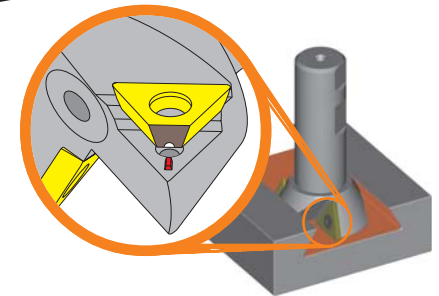
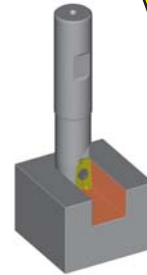

In order for the dovetail cutter to be properly used, a 90° slot must first be cut into the material. This first cut allows clearance for the neck of the dovetail cutter during the final cut.

To ensure repeatability, **DOVEDEX** cutters are designed with a precision machined alignment key that is integrated into each insert pocket. Combine this with the advanced design of the **IDEX** insert and the result is a superior dovetail cutter.

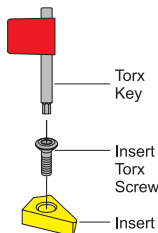
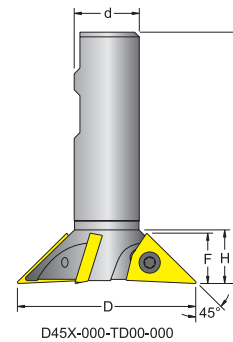

For spare part information see page E-177.

Description	Part No. 733101-	C	D	d	F	H	No. Inserts	<b>IDEX</b> Gage Insert	Insert Torx Screw	Torx key
D45X-050-TD09-037	65233	2.390	0.500	0.375	.247	.125	1			
D45X-075-TD09-037	65234	2.390	0.750	0.375	.247	.214	2	090202	TS-25.45-6M1	T-7
D45X-100-TD09-050	65235	2.390	1.000	0.500	.250	.244	3			
D45X-137-TD17-062	65236	2.940	1.375	0.625	.375	.320	2	17T304	TS-4.7-8M1	T-15
D45X-187-TD17-075	65237	2.940	1.875	0.750	.468	.444	3			
D45X-225-TD25-100	65238	3.500	2.250	1.000	.700	.696	2	250404	TS-5.8-10M1	T-20
D45X-250-TD25-100	65239	3.500	2.500	1.000	.700	.700	3			